

INON

INON Single Hole Rubber Bush Type L

Thank you for purchasing INON product.

The INON **Single Hole Rubber Bush Type L** is an angled fiber optics adapter to hold one compatible "fiber optics" product.

- Package contents:**
- Single Hole Rubber Bush Type L ① ×1
 - Single Hole Rubber Bush Type L Body ② ×1
 - M2 Cap Screw ③ ×2
 - Rubber Bush Type L Case ④ ×1
 - Rubber Bush Type L Case (screw) ⑤ ×1
 - M2 Allen Wrench (WAF: 1.5 mm) ⑥ ×1
 - This user manual ×1

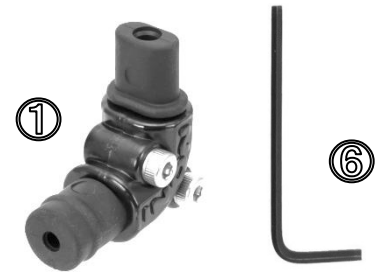

- Compatible Optical D Cable (as of March 2021)**
- Optical D Cable SS Type L
 - Optical D Cable Type L
 - Optical D Cable L Type L
 - Optical D Cable LL Type L

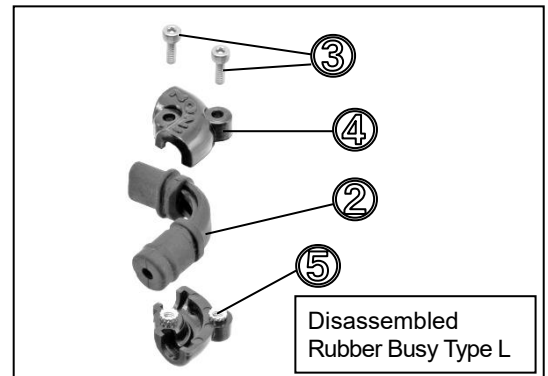

- How to attach:**
- To set "Optical D Cable Type L" product, it is necessary to disassemble the **Single Hole Rubber Bush Type L**. First remove 2 x **M2 Cap Screw**③ by supplied **M2 Allen Wrench**⑥ and separate **Rubber Bush Type L Body**② from **Rubber Bush Type L Case**④/**Rubber Bush Type L Case (screw)**⑤ (A). Then insert "bear end of fiber optics cable" in the cable channel (ϕ 2mm/0.08inch) of the **Rubber Bush Type L Body**② (B) (Make sure to insert the bear end all the way so that there is no gap between the bear end surface of the cable and surface of the other end of the **Rubber Bush Type L**. If the bear end of the cable has not been properly set, it may cause inaccurate exposure by an external strobe or even failing to fire the strobe)

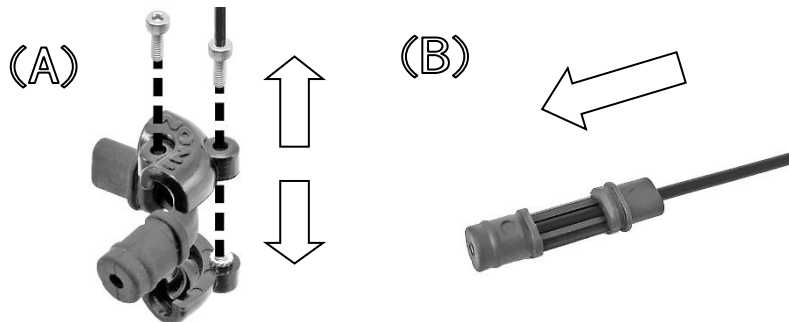

Then reassemble the **Rubber Bush Type L** by following reverse procedure to disassembling it. Sandwich **Rubber Bush Type L Body**② between **Rubber Bush Type L Case**④ and **Rubber Bush Type L Case (screw)**⑤ so that the rubber bush seats in the case completely as per below image (C). Then interlock two cases with 2 x **M2 Cap Screw**③ by supplied **M2 Allen Wrench** (D).

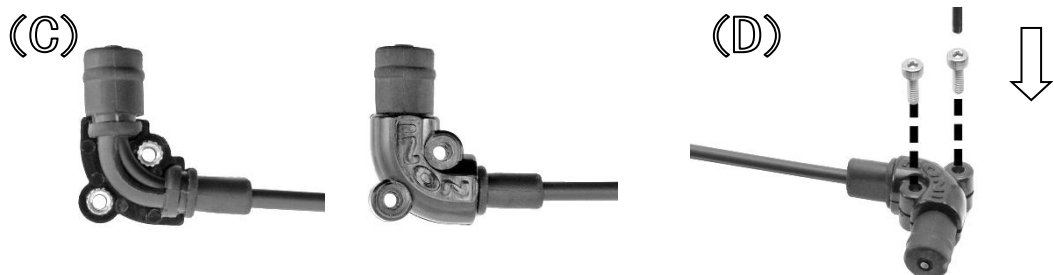

INON Inc. 2-18-9 Dai, Kamakura, Kanagawa 247-0061 JAPAN
E-mail: support@inon.co.jp Fax: +81(0)467-48-2178
URL: <http://www.inon.jp/>

As of March 2021